



PIR Motion Sensor User Guide

PIR Motion Sensor alarms when motion is sensed. It is battery powered and requires no installation tools. A Pyroflex™ sensor with HighBar™ signal processing allows for industry-leading pet immunity and catch performance.

Features

- Industry-leading pet immunity and catch performance
- Secure encrypted wireless transmissions
- Mountable on walls or in corners
- 3 year warranty

Enroll by sending an enrollment signal from the sensor with the help on an installation specialist.

Options for sending an Enrollment Signal

- Remove the battery tab, OR
- Remove the cover to trip tamper

Install using the attached 3M VHB® tape to adhere the motion sensor on a wall or in a corner. The tape should be applied to the **back** when wall mounting or to the **back bevels** when corner mounting. Alternatively, screw mounting can be done by punching out the mounting screw holes.

Installation Tips

- Mount 7.5 to 9.5 feet from the floor for an optimal balance between catch performance and pet immunity.
- Remove the cover and circuit board before trying to punch out the screw mounting holes.
- Ensure the bug foam stays intact and snug around the IR sensing element when re-installing the circuit board.

Pet Tips

- For installation with pets over 60 lbs please advise your installation specialist.

- See **Pro Tips** for recommendations about using 3M VHB tape

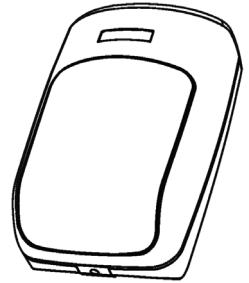

Mounting Screw Holes
(optional)

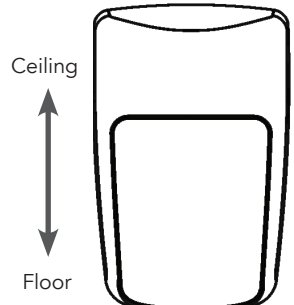
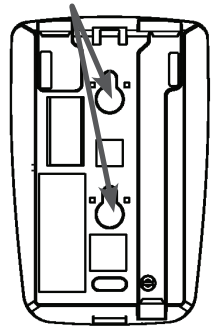

Pro Tips

Walk test mode is entered by pressing the motion sensor's tamper button. The walk test lasts three minutes.

Walk Test Operation

- The walk test LED turns on when motion is sensed.
- The motion sensor performs a re-calibration after each activation. The re-calibration takes about 30 seconds. The sensor will NOT sense motion during the re-calibration.
- Wireless transmissions are sent for each detection, so walk test mode can also be used to test the panel.

Motion lockout is active for three minutes after a motion event is detected. During the motion lockout period, motion events will be ignored.

Motion sensitivity can be adjusted by the sensitivity jumper on the circuit board.

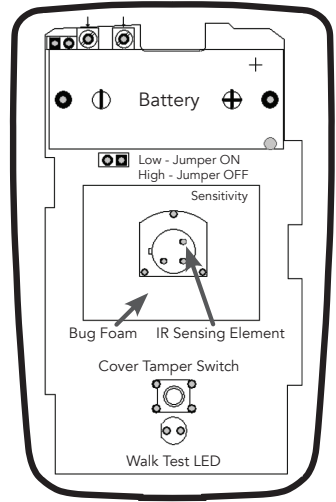

- Jumper Installed (lower sensitivity): Detects person in 3 to 5 steps. Increases pet immunity. Usually for security applications.
- Jumper NOT Installed (higher sensitivity): Detects person in 2 to 4 steps. Usually for occupancy applications.

Pet immunity is optimized when the motion sensor is mounted at 7.5 to 9.5 feet high and aimed **away** from house features that could allow pets to be high in the detection field (e.g. stairs, counter tops, tall furniture).

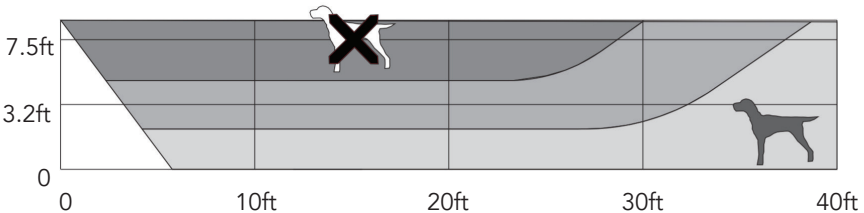

Motion catch performance is best when the motion sensor is positioned so a person would typically walk across the front of the motion sensor instead of directly toward the motion sensor.

Motion Detection Tips

- Provide a clear line-of-sight to the monitored area and remember that glass blocks infrared energy (PIR = Passive InfraRed).
- Aim away from windows and sunlight.
- Aim away from air conditioners, heaters or heating/cooling vents.

3M VHB Tape works great if the surface is properly prepared and firm pressure is applied for over 10 seconds.

Surface Preparation

- Clean the surface
- Ensure the mounting surface temperature is above 50 °F

To replace the battery press in the latch on the bottom of the motion sensor to remove the cover. Replace battery and reinstall the cover.

Side field of view for a mounting height of 7.5 feet

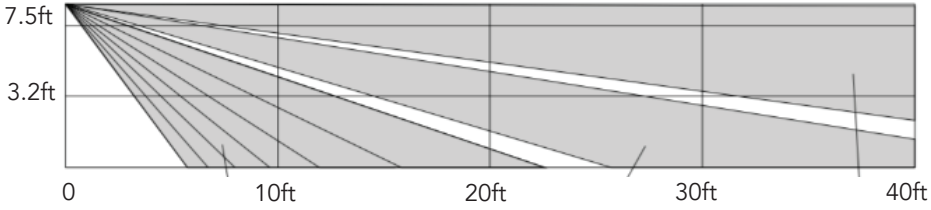

Side field of view for a mounting height of 9.5 feet

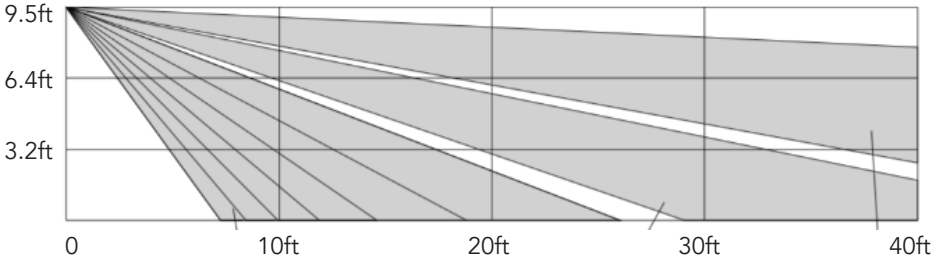

Top field of view

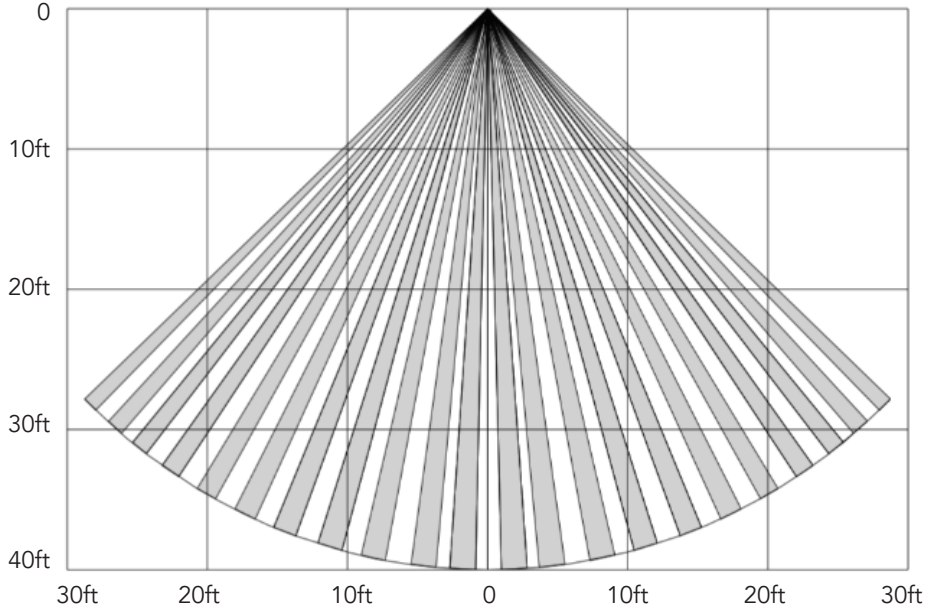

Specifications

Physical	
Housing Dimensions	3.50 x 2.40 x 1.70 inches (8.9 x 6.1 x 4.3 cm)
Weight with Battery	3.2 ounces (91 grams)
Mounting Fastener	3M VHB Tape or Screws (provided)
Environmental	
Operating Temperature	32 to 120 °F (0 to 49 °C)
Maximum Humidity	85% non-condensing relative humidity
Sensor Specifications	
Frequency	433.92 MHz
Pet Immunity	Two 50-pound dogs or one 75-pound dog
Replacement Battery	One CR123A
Nominal Battery Life	6 to 8 years
Battery Voltage	3.0 VDC (Nominal), 2.2 VDC (Low)
Optimal Mounting Height	7.5 to 9.5 feet (2.3 to 3.0 m)
Transmitted Indications	Cover Tamper, Low Battery, Supervision

Specifications subject to change without notice



PIR MOTION SENSOR – 020

Tech Support:

1-855-76-THINK

(1-855-768-4465)

www.thinkprotection.com